

# Instructions



**1 Check caliper clearance before removing the wheels.** If the brake calipers do not allow proper clearance, the weight can be placed in a lateral position on the inner or outer area of the wheel just inside the flange area.

**2 Use a properly calibrated wheel balancer to determine the location and amount of weight.** If a weight is put on the drop center *in static mode*, be sure to reduce the rim diameter setting to 1.5" less than the tire size.



**3 Thoroughly clean the wheel surface. Spray XACTCleaner directly on the wheel surface and use clean paper towels to clean and dry the weight location.**

**WARNING:**

- Even NEW wheels have residue on the wheel surface that will compromise adhesion -- thoroughly clean new wheels.
- Shop rags leave residue on the wheel surface that will compromise the adhesion
- Brake Cleaner leaves residue on the wheel surface that will compromise the adhesion of weights and can damage wheel finishes -- use XACTCleaner.
- Avoid contact with the surface that has been cleaned.



**4 Gently place the weight on the wheel using the T logo to center the weight at the location called for by the balancer.** BE CAREFUL: Do not let the adhesive touch anything after the protective backing is removed. *When gently placed on the wheel surface, the weight can be repositioned if necessary.*

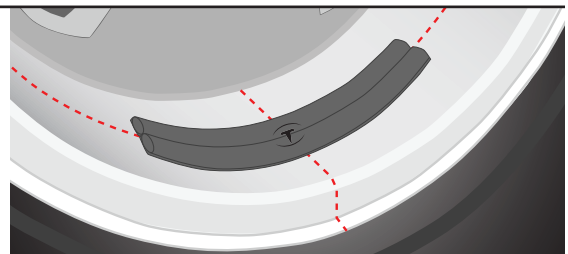

**5 Spin again to confirm balance.** If repositioning the weight does not balance the assembly, place additional weight as called for by the balancer. When adding another XACTBalance weight, add the second weight at the exact position requested by the balancer. The second weight should be attached next to and parallel with the first weight.



**6 Press firmly into place (this makes the adhesion permanent).**

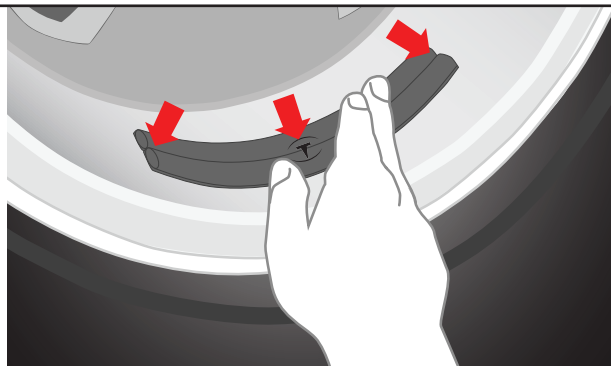

**Troubleshooting Tips:**

1. Verify that the Wheel Balancer has been properly calibrated and is set up for "tape-on" weights.
2. Is the wheel properly mounted and seated on the balancer?
3. Check for runout of the wheel assembly.
4. In cold conditions, a heat gun may be used to carefully warm the wheel surface and the XACT-Balance weight.

